

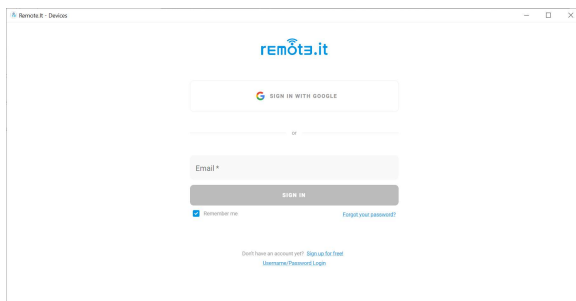

Connecting with *remote.it* using Windows desktop app

If you have not installed the desktop application, you can get it here:
<https://www.remote.it/download>.

Once you have downloaded the application and created an account, here is how you connect to your Hive using the desktop application. These instructions assume you have completed the creation of the *remote.it* services.



1. Launch the app and sign into your account with your email and password

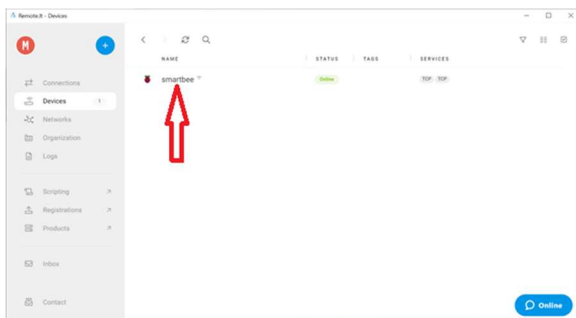

2. Click on the smartbee device listed. This will bring you to the connection page for the services you created earlier. Select the "web connection" in the service section.

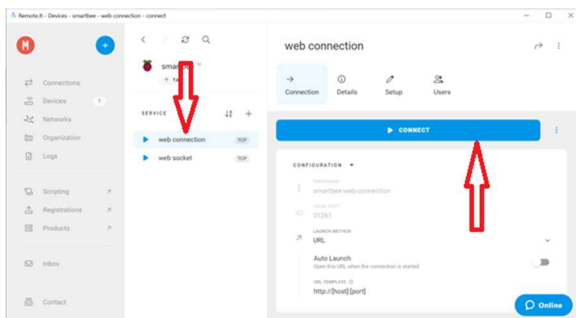

3. First select the "web connection" service. Then click on the blue connect bar.

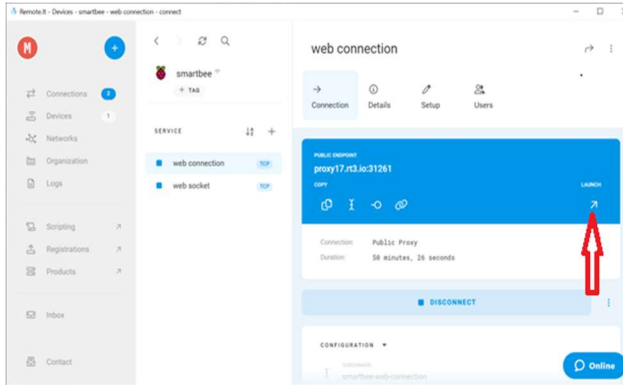

4. The display changes to show the connection has been made. Press the “Launch” arrow. This will launch your web browser and open a SmartBee login page.

Note: Do not enter your password and attempt to login at this time. Return to the *remote.it* app to complete the “web socket” connection.

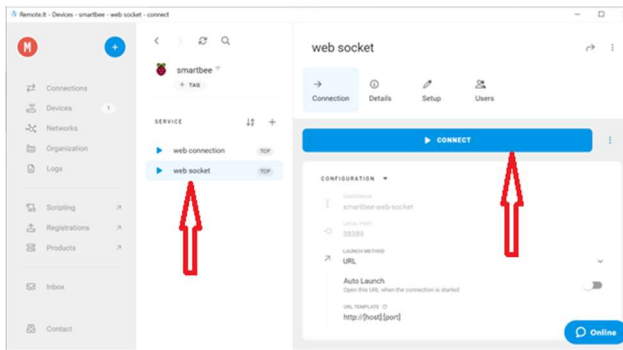

5. First select “web socket” service. Then click on the blue connect bar.

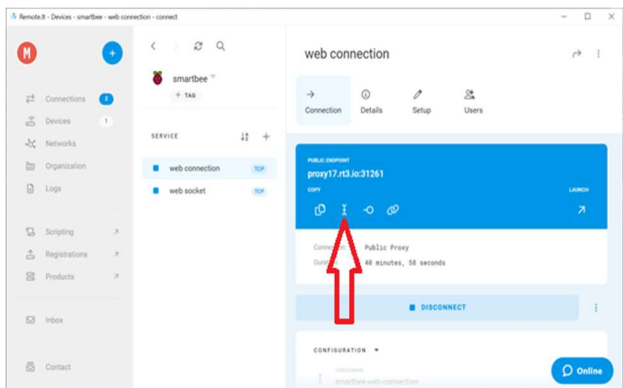

6. From the “web socket” connection, copy the “HOST” by clicking the icon shown.

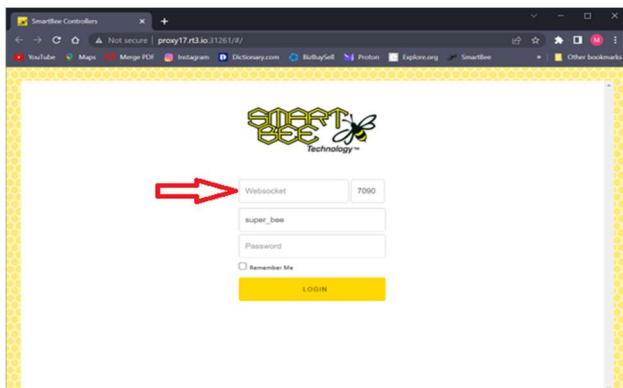

7. Clear the contents of the box shown and then paste the “HOST” information.

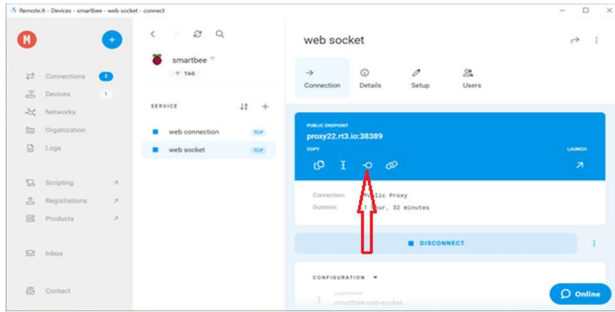

8. From the “web socket” connection copy “PORT” information in the blue bar by clicking on icon shown below

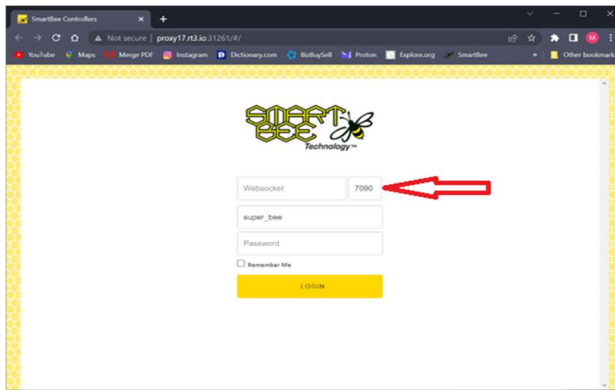

9. Return to the SmartBee login page and Clear the contents of the box and paste the “PORT” where shown.

10. Enter your password and hit login. You should now be connected to your Hive